

HYUNDAI

OPEN DIESEL GENERATOR

Technical Data

Generator Model		DHY12500LE	DHY12500LE-3
Frequency	Hz	50	50
Rated power	kVA	10	12.5
	kW	10	10
Max. power	kVA	11	13.75
Voltage	V	220	220V/380V
Rated current	A	45	19.3
Phase		1-phase	3-phase
Fuel tank capacity	L	25	25
Fuel consumption 100% load	L/Hours	4.83	4.83
Running time 50% load	Hours	10	10
Sound pressure level(7m 75% load)	dB(A)	82	82
Battery		12V/36Ah	12V/36Ah
Engine Model		LA290	LA290
Rated power	Hp	22.0	22.0
Start mode		Electric	Electric
Displacement	cc	836	836
Oil capacity	L	1.7	1.7
Alternator Model		AL12	AL12-3
Rated power	kVA	12	13
Power factor	cosφ	1	0.8
Voltage regulation		Blush / AVR	Blush / AVR
Dimension and Weight			
Net weight	kg	170	174
Gross weight	kg		
Product dimension (L×W×H)	mm	910*578*800	
Box dimension (L×W×H)	mm		
Capacity	unit / container	51/20GP; 102/40GP; 102/40HQ	



LED5
PRECISE OVER LOAD PROTECTION



LED3

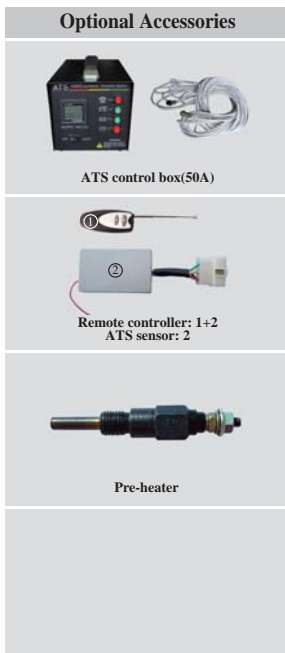

Electrical standard and options	DHY12500LE	DHY12500LE-3
1-phase (2×16A European sockets)	●	×
3-phase (1×16A European socket)	×	●
American;UK;Australian sockets;etc	○	○
Display LED5	●	●
Display LED3	○	○
Prosize overload protection	●	●
Common overload protection	○	○
E-stop button	○	○
DC output:12V / 8.3A	●	●
Earth connection	●	●
Pre-heater	×	○
ATS sensor	×	○
Remote control	×	○
ATS control box(50A)	×	○
Mechanical standard and options		
Basic color: Pantone black C	●	●
Alternator: Steel plate Q195	○	○
Alternator: Silicon steel plate DW800	●	●
Decompression handle	○	○

Option : ○ Standard feature : ● No available : ×

